

1920?

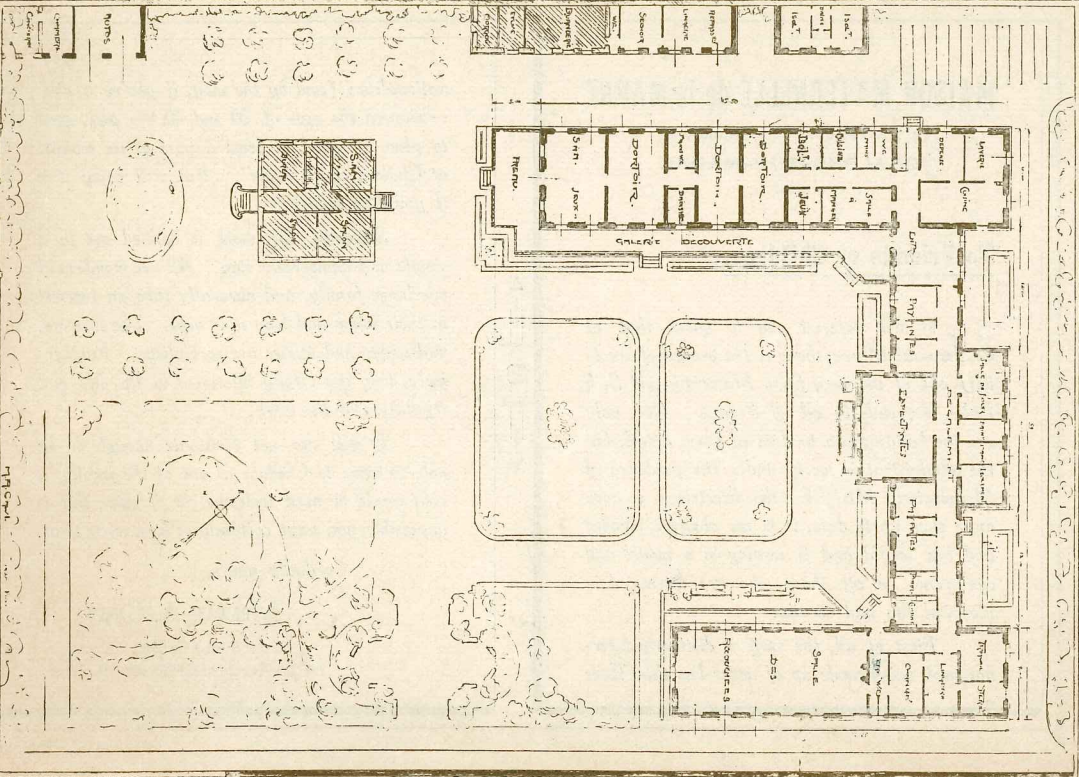

MEMORIAL HOSPITAL OF THE  
MISSION DES AMIS.

H. A. Cowell, 1920



MAISON MATERNELLE DE CHALONS SUR MARNE.

## MEMORIAL HOSPITAL OF THE MISSION DES AMIS

**What is it?** It's a Maternity Hospital and it's a Baby Hospital all under one roof.

**Where is it?** At Châlons-sur-Marne, 110 miles due east of Paris.

**Who started it?** It was started on December 9th, 1914, by the *Mission des Amis*.

**Who's running it now?** A *Voluntary French Committee*, made up of people from all parts of the Marne and who have legally organized themselves under the name of "*Maison Maternelle de la Marne*" (translated freely) "The Maternity Home for the Department of Marne".

**Who's paying for the NEW BUILDING? WHY?** The English and American Friends and their co-workers. *Because*, this work which we started and which the French are going to carry on this truest work of Reconstruction, that of building up the human bodies and mind of those who *are* and *will be* the permanent reconstructors of France, would have gradually died and completely gone out of existence simply for want of a *place* to live.

Figuratively speaking the "Mission des Amis" (and all its represents) is the Father of the work. The Voluntary French Committee is the Mother. - To be sure a true Mother can make a home out of the most tumbled down old shanty, BUT on the other hand a true Father always does all he can to provide the very best home possible for his family. That's WHY the New Buildings are slowly, but very solidly and substantially showing themselves above the ground at 47, Avenue de Strasbourg, Châlons-sur-Marne.

## Ⓟ DID YOU KNOW THAT Ⓟ

7,000 patients have been treated in our Consultation Clinic in Châlons.

1,075 refugee children from the invaded area were taken care of for a more or less prolonged period and that none of them died.

980 Babies have been taken in at the "Crèche Pouponnière" sick, abandoned babies and children of mothers nursed at the Maternity).

1170 Babies have been born in the Maternité.

\$ 146 or £ 30 will maintain a baby's cradle for a year.

\$ 400 or £ 80 will maintain a mother's bed and a baby's cradle for a year.

\$ 10,000 will endow a mother's bed and a baby's cradle *for ever*.

The **New Building** will accommodate 30 beds for mothers, 60 cradles for the children and 30 beds for the staff and servants.

The **New Building** and its property is going to cost about 1,500,000 francs.

There are all kinds of medical equipment *we'd like to install* to make the New Hospital a model institution in every detail.

If you endow a bed or donate any part of the equipment in the new building there would be erected a little bronze plate like this →



## MAISON MATERNELLE de la MARNE

47, Avenue de Strasbourg, 47  
CHALONS-SUR-MARNE

### To Friends of Children,

*It will interest you to know that at Châlons-sur-Marne there is (in process of erection) one of the very finest Maternity and Sick Baby Hospitals in all of France. Not only are the buildings up to date in every detail, but the administration work, under the guidance of Mademoiselle MERLE (the directrice), is even more than up to date, it is an absolute novelty and has served and is serving as a model and eye-opener to all those who are interested in Hospital life and service.*

*First of all, the staff is distinctly international, being made up of never less than three*

*nationalities (and by the way, if you're a girl, —between the ages of 20 and 40!— you want to plan to spend at least a term of six months at Châlons as an "aide". You will enjoy it— if you like babies!)*

*Secondly, the work is carried out in a simple and democratic way. All are members of one large family, and naturally take an interest in their home and how it is kept. The Doctors, mid-wives and nurses are specialists. Furthermore, they are vitally interested in the life and reputation of the work.*

*If you are not fortunate enough to be able to come to Châlons as one of the family, a visit would be most welcome, or if even this is impossible you must certainly at least write to us.*

Cordially yours,

MELVIN A. CAWL,

Designer and General Director  
for the erection of the new Buildings.